



SUBMITTAL SHEET

FERO V-TIE™

The FERO® V-Tie is the leading wire-tie available. Its proprietary "V" shape is engineered to maximize mortar engagement, leading to greater pullout and push through capacity from the mortar bed. This generally results in at least 25% better performance. The FERO V-Tie provides an easier shape to loop into plates, resulting in faster installation. FERO V-Ties are available in a large assortment of sizes to suit any cavity space.



FERO V-TIE

- Manufactured from 3/16" (4.76mm) diameter wire
- Engages more mortar than any other tie

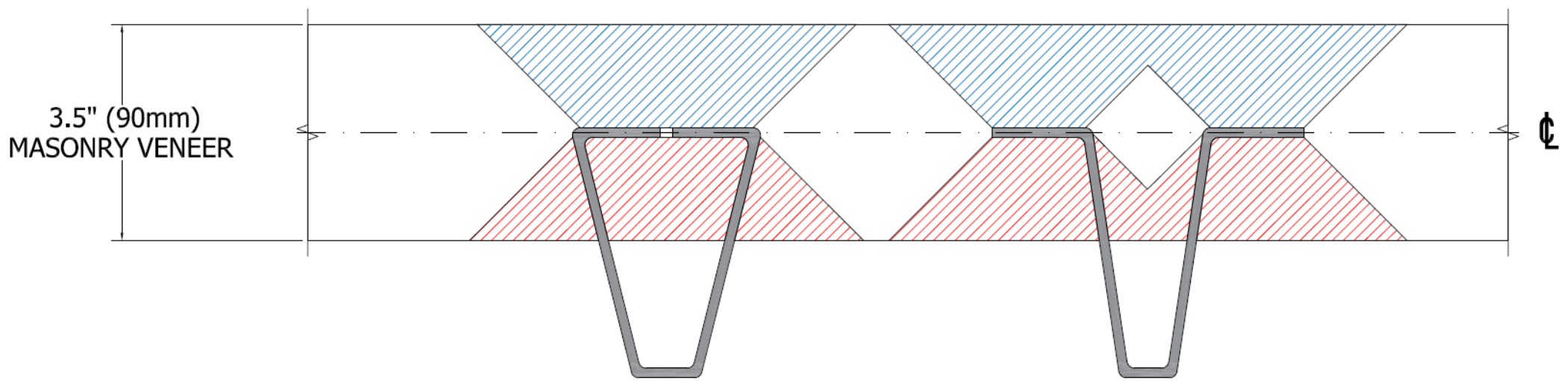

CONVENTIONAL TIE

8.1 sq-in ENGAGED IN TENSION AND COMPRESSION

FERO V-TIE™

10.9 sq-In ENGAGED IN TENSION AND COMPRESSION

ORDER FERO V-TIES

<input type="checkbox"/>	2.4" (60mm)	<input type="checkbox"/>	3.1" (80mm)
<input type="checkbox"/>	3.9" (100mm)	<input type="checkbox"/>	4.7" (120mm)
<input type="checkbox"/>	5.5" (140mm)	<input type="checkbox"/>	6.3" (160mm)
<input type="checkbox"/>	7.1" (180mm)	<input type="checkbox"/>	7.9" (200mm)
<input type="checkbox"/>	8.9" (225mm)	<input type="checkbox"/>	9.8" (250mm)
FINISH:		<input type="checkbox"/> HDG	<input type="checkbox"/> SS
# of ties required:			

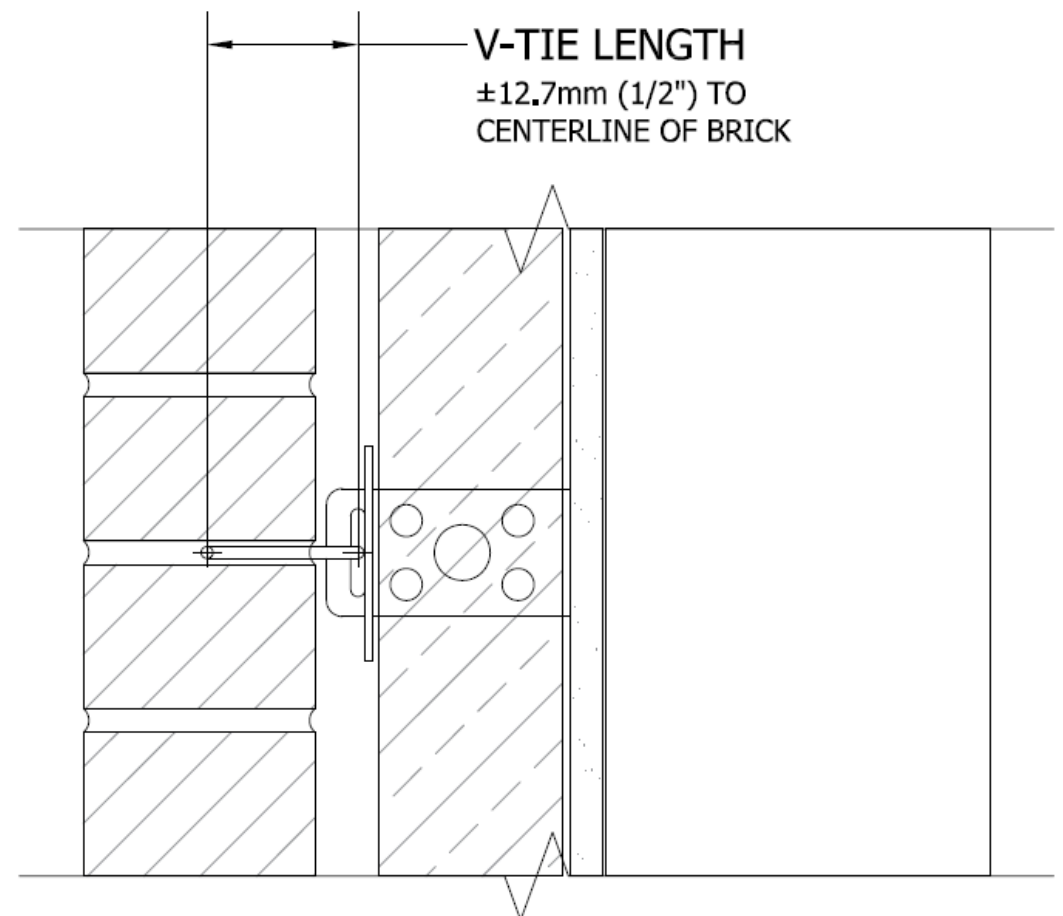

V-Tie:
Carbon Steel (ø3/16") ASTM A82
Stainless Steel (ø3/16") ASTM A580 Type 304

Hot-Dip Galvanizing:
Min. 460 g/m²/side
ASTM A123, ASTM A153 Class B

LEED/Recycled Content:
Steel: 87.6% post-consumer content; 6.8% pre-consumer content
Plastics: 100% post-consumer

All FERO products include complete documentation with descriptions, technical illustrations and images. Installation requirements and methods are clearly detailed.

Satisfies requirements of CSA A370, ACI 530.1/ ASCE 6/ TMS 602, IBC, ASTM A123, ASTM A153, Class B.