

The FERRO® Thermal Exterior Panel Support is a low-cost, easy-to-install, and thermally efficient solution for a various exterior paneling systems. The FERRO Thermal Exterior Panel Support is pushed off the backup wall allowing insulation to be continuous, whereas traditional girts or secondary structural framing form a large thermal bridge across its cut through the insulation. This also greatly reduces the amount of material needed, particularly for walls with thicker insulation. The FERRO Thermal Exterior Panel Support can be used with any holed variant of FERRO Thermal Tie™ Masonry Connectors, fastening to any backup wall and maintaining the same benefits of the FERRO Thermal Tie Masonry Connector it attaches to. The FERRO Thermal Exterior Panel Support can be used structurally to support the weight of the panels and transfers lateral loads to the backup wall.

FERRO THERMAL EXTERIOR PANEL SUPPORT:

1. FERRO Thermal Exterior Panel Support
 - Provides a flat universal interface for securing most panel connectors from other manufactures
2. FERRO Thermal Tie - Holed Rap-Tie® Masonry Connector (separate order form)
FERRO Thermal Plate
 - Incorporation of thermal holes through the body of the plate reduces thermal bridging
3. Diamond Insulation Support
 - Restrains the insulation from separating from the structural backing/air barrier

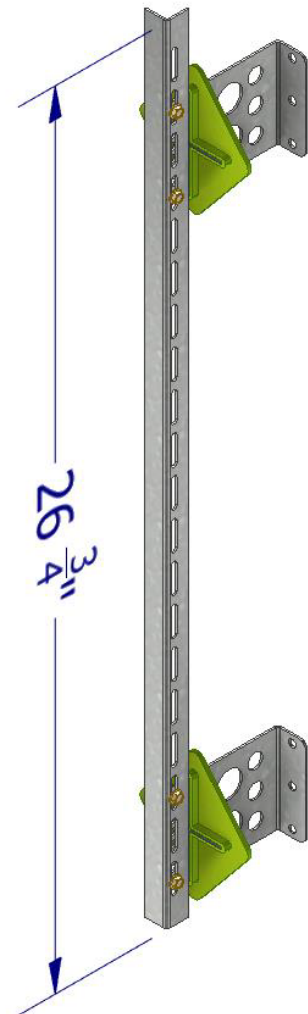
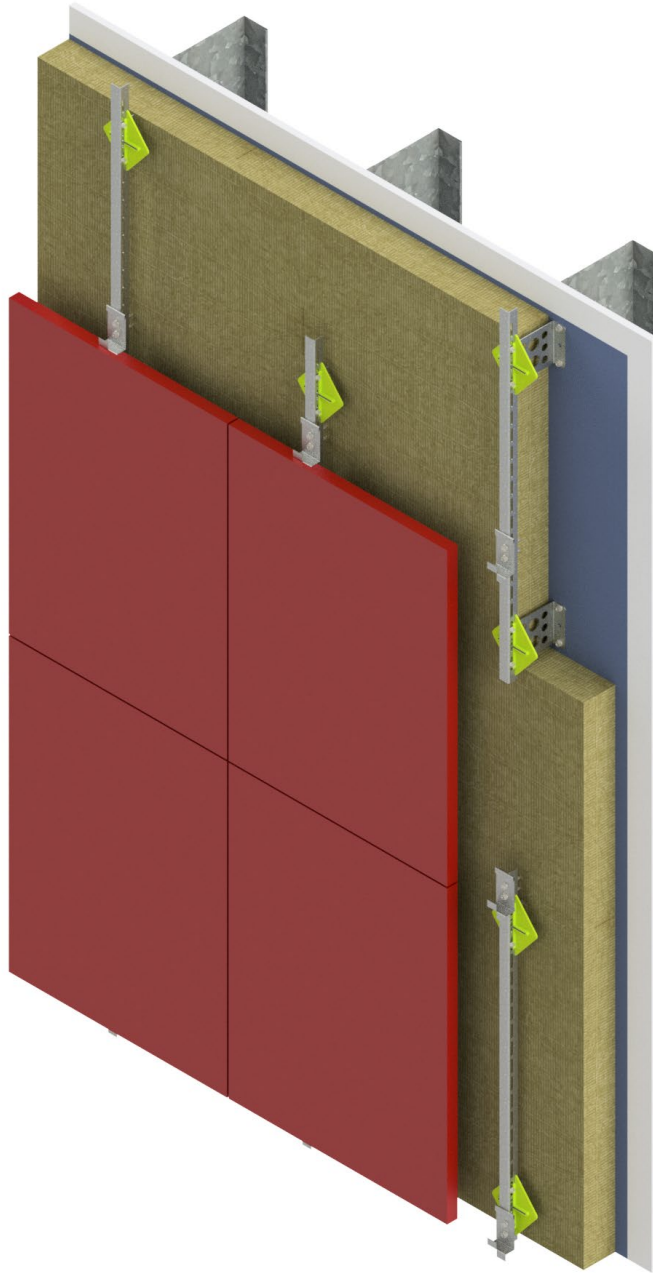

ORDER FERRO THERMAL PANEL EXTERIOR SUPPORTS

supports required:

Panel Support
Carbon Steel (16 gauge) ASTM A653/A924 SS230
Stainless Steel (16 Gauge) ASTM 240 Type 304L

L-Plate:
Carbon Steel (16 Gauge) ASTM A1011 CS Type B
Stainless Steel (16 Gauge) ASTM 240 Type 304L

V-Tie:
Carbon Steel (ø3/16") ASTM A82
Stainless Steel (ø3/16") ASTM A580 Type 304

Insulation Support:
100% Recycled Polyethylene

Hot-Dip Galvanizing:
Min. 460 g/m²/side
ASTM A123, ASTM A153 Class B

LEED/Recycled Content:
Steel: 87.6% post-consumer content; 6.8% pre-consumer content
Plastics: 100% post-consumer

All FERRO products include complete documentation with descriptions, technical illustrations and images. Installation requirements and methods are clearly detailed.

