

FERO Thermal Cladding Support is a low-cost, easy-to-install, and thermally-efficient solution for cladding and siding. FERO Thermal Cladding Support is pushed off the backup wall allowing insulation to be continuous, whereas traditional girts or secondary structural framing form a large thermal bridge across its cut through the insulation. This also greatly reduces the amount of material needed, particularly for walls with thicker insulation. FERO Thermal Cladding Support can be used with any holed FERO Thermal Tie™ Masonry Connector, fastening to any backup wall and maintaining the same benefits of the FERO Thermal Tie™ Masonry Connector it attaches to.

**FERO THERMAL CLADDING SUPPORT:**

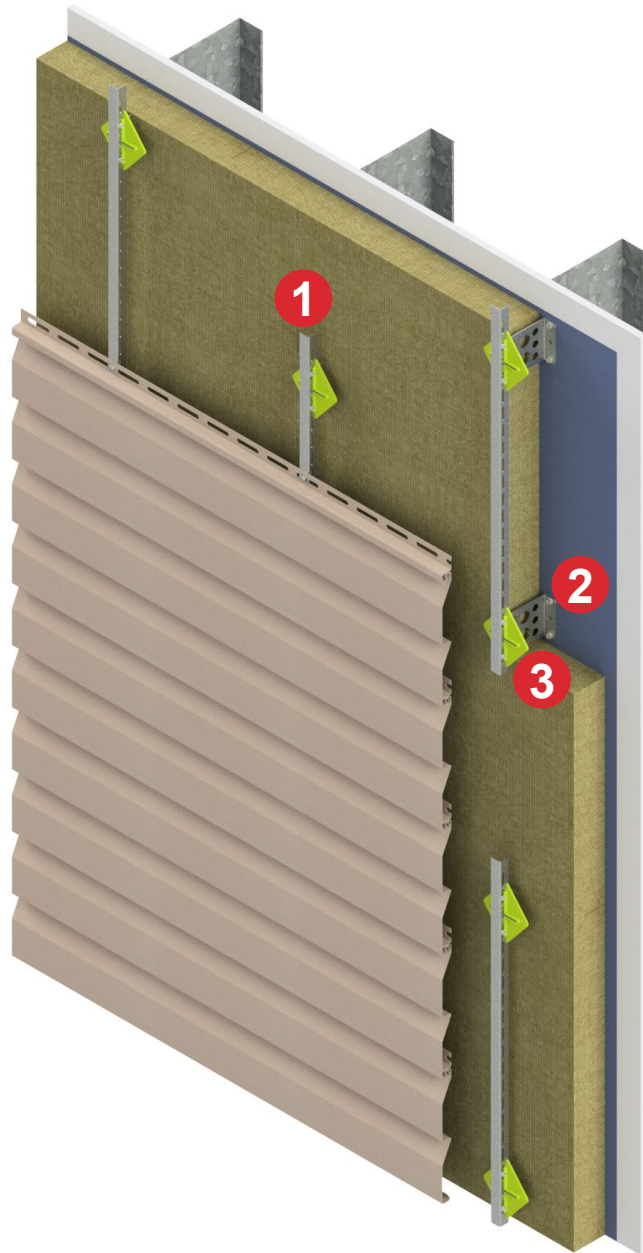

1. FERO Cladding Support
  - Provides a rigid connection surface for cladding/siding secures exterior insulation firmly in place
2. FERO Thermal Holed Tie or Connector (order form)  
FERO Thermal Plate
  - Incorporation of thermal holes through the body of the plate reduces thermal bridging
3. Diamond Insulation Support
  - Restrains the insulation from separating from the structural backing/air barrier

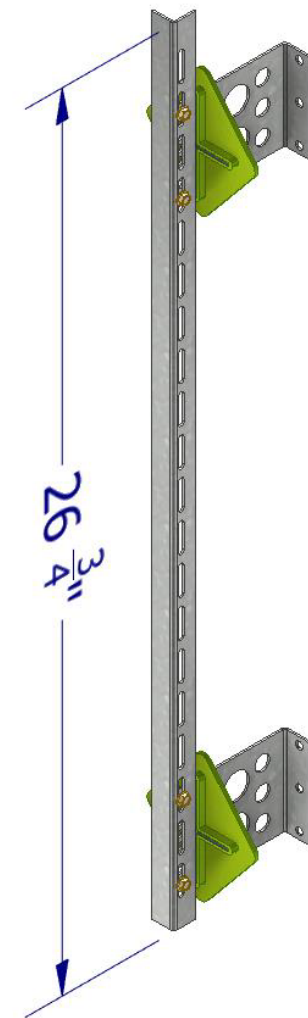

**ORDER FERO THERMAL CLADDING SUPPORTS**

# of supports required:

**Cladding Support**  
Carbon Steel (16 gauge) ASTM A653/A924 SS230  
Stainless Steel (16 Gauge) ASTM 240 Type 304L

**L-Plate:**  
Carbon Steel (16 Gauge) ASTM A1011 CS Type B  
Stainless Steel (16 Gauge) ASTM 240 Type 304L

**V-Tie:**  
Carbon Steel (ø3/16") ASTM A82  
Stainless Steel (ø3/16") ASTM A580 Type 304

**Insulation Support:**  
100% Recycled Polyethylene

**Hot-Dip Galvanizing:**  
Min. 460 g/m<sup>2</sup>/side  
ASTM A123, ASTM A153 Class B

**LEED/Recycled Content:**  
Steel: 87.6% post-consumer content; 6.8% pre-consumer content  
Plastics: 100 % post-consumer

All FERO products include complete documentation with descriptions, technical illustrations and images. Installation requirements and methods are clearly detailed.